

Cranked handles with retractable handle

Aluminum, retractable mechanism Stainless Steel

SPECIFICATION

Body
Aluminum
plastic coated
black, RAL 9005, textured finish **SW**
silver, RAL 9006, textured finish **SR**
hub machined
Hub cover
light grey
Retractable handles GN 798.5 (see page 586)
Plastic, Technopolymer
black, matt finish
Retractable mechanism
Stainless Steel
Axle parts AISI 303
Flat base Sintered Steel AISI 316



INFORMATION

The handpiece of the cranked handle GN 472.5 is locked in a tapered bore in the operating position. For tilting, the handle must first be pulled out of the taper in axial direction.
A compression spring holds the handle in both end positions. When folded out, it automatically re-engages.

TECHNICAL INFORMATION

- Square DIN 79 (see page A16)
- Cross holes GN 110 (see page A17)
- ISO-Fundamental Tolerances (see page A21)
- Stainless Steel characteristics (see page A26)

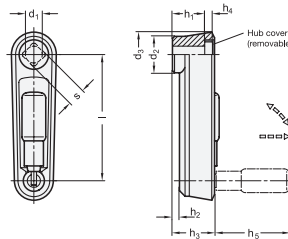

GN 472.5

Description	l	d1 H7	s H11	d2	d3	h1	h2	h3	h4	h5 ≈	Ø Handle	△
GN 472.5-80-B10-SW	80	B 10	-	23	30	19.5	4	25.5	4.3	43	16	118
GN 472.5-80-B10-SR	80	B 10	-	23	30	19.5	4	25.5	4.3	43	16	118
GN 472.5-80-V10-SW	80	-	V 10	23	30	19.5	4	25.5	4.3	43	16	118
GN 472.5-80-V10-SR	80	-	V 10	23	30	19.5	4	25.5	4.3	43	16	118
GN 472.5-100-B12-SW	100	B 12	-	26.7	35	23.5	5.5	29.5	4.2	57.5	18	197
GN 472.5-100-B12-SR	100	B 12	-	26.7	35	23.5	5.5	29.5	4.2	57.5	18	197
GN 472.5-100-V12-SW	100	-	V 12	26.7	35	23.5	5.5	29.5	4.2	57.5	18	197
GN 472.5-100-V12-SR	100	-	V 12	26.7	35	23.5	5.5	29.5	4.2	57.5	18	197
GN 472.5-125-B14-SW	125	B 14	-	28	37	30.5	10.5	36.5	4.2	76.5	24	283
GN 472.5-125-B14-SR	125	B 14	-	28	37	30.5	10.5	36.5	4.2	76.5	24	283
GN 472.5-125-V14-SW	125	-	V 14	28	37	30.5	10.5	36.5	4.2	76.5	24	283
GN 472.5-125-V14-SR	125	-	V 14	28	37	30.5	10.5	36.5	4.2	76.5	24	283